

# PERMIT

## CITY OF NAPOLEON - BUILDING DEPARTMENT

255 West Riverview Avenue, Napoleon, Ohio 43545 - 419-592-4010

Permit No. 01030 Issued August 28, 1985  
date

Job Location 615 Leonard  
address

Lot \_\_\_\_\_  
sub-div or legal discript

Issued By Richard G. Hayman  
building official

Owner Lucy Grieser  
name tel.

Address 615 Leonard

Agent John Gustwiller 395-2201  
builder-eng.-etc. tel.

Address RR 6 17117 Hill Rd Defiance

Description of Use Replace old service with  
new 100 amp

Residential Single Family  
no. dwelling units

Commercial \_\_\_\_\_ Industrial \_\_\_\_\_

New \_\_\_\_\_ Add'n. \_\_\_\_\_ Alter \_\_\_\_\_ Remodel \_\_\_\_\_

Mixed Occupancy \_\_\_\_\_

Change of Occupancy \_\_\_\_\_

Estimated Cost \$ 500.00

FEES	BASE	PLUS	TOTAL
BUILDING			
ELECTRICAL	5.00		5.00
PLUMBING			
MECHANICAL			
DEMOLITION			
ZONING			
SIGN			
WATER TAP			
SEWER TAP			
TEMP. ELECT.			
ADDITIONAL PLAN REVIEW	Struct. _____ hrs	Elect. _____ hrs	
TOTAL FEES.....			5.00
LESS MIN. FEES PAID _____ date _____			-0-
BALANCE DUE.....			5.00

### ZONING INFORMATION

district	lot dimensions	area	front yd	side yds	rear yd
A					
max hgt	no pkg spaces	no ldg spaces	max cover	petition or appeal req'd	date appr

### WORK INFORMATION:

Size: Length \_\_\_\_\_ Width \_\_\_\_\_ Stories \_\_\_\_\_ Ground Floor Area \_\_\_\_\_

Height \_\_\_\_\_ Building Volume (for demo. permit) \_\_\_\_\_ cu. ft.

Electrical: \_\_\_\_\_  
brief description

Plumbing: \_\_\_\_\_  
brief description

Mechanical: \_\_\_\_\_  
brief description

Sign: \_\_\_\_\_ Dimensions \_\_\_\_\_ Sign Area \_\_\_\_\_  
type

Additional Information: \_\_\_\_\_

Date \_\_\_\_\_ Applicant Signature \_\_\_\_\_  
owner-agent

PAID  
 SEP 05 1985  
 CITY OF NAPOLEON

# INSPECTION RECORD

	UNDERGROUND			ROUGH-IN						FINAL		
	Type	Date	By	Type	Date	By	Type	Date	By	Type	Date	By
<b>PLUMBING</b>	Building Drains			Drainage, Waste & Vent Piping			Indirect Waste			Drainage, Waste & Vent Piping		
	Water Piping									Backflow Prevention		
	Building Sewer			Water Piping			Condensate Lines			Water Heater		
	Sewer Connection									FINAL APPROVAL		
<b>MECHANICAL</b>	Refrigerant Piping			Refrigerant Piping			Chimney(s)			Grease Exhaust System		
				Duct Furnace(s)			Fire Dampers			Air Cond. Unit(s)		
	Ducts/ Plenums			Ducts/ Plenums			<input type="checkbox"/> Radiant Htr(s) <input type="checkbox"/> Unit Htr(s)			Refrigeration Equipment		
				Duct Insulation			Pool Heater			Furnace(s)		
			Combustion Products Vents			Ventilation <input type="checkbox"/> Supply <input type="checkbox"/> Exhst.				FINAL APPROVAL		
<b>ELECTRICAL</b>	Conduits & or Cable			Conduits/ Cable			<input type="checkbox"/> Range <input type="checkbox"/> Dryer			Temp Service Temp Lighting		
	Grounding & or Bonding	9/6/85	JKH	Rough Wiring			<input type="checkbox"/> Generator(s) <input type="checkbox"/> Motors			Fixtures Lampholders		
	Floor Ducts Raceways			Service Panel Switchboard			<input type="checkbox"/> Water Htr <input type="checkbox"/> Welder			Signs		
	Service Conduit	9/6/85	JKH	Busways Ducts			<input type="checkbox"/> Heaters <input type="checkbox"/> Heat Cable			Electric Mtr. Clearance		
	Temporary Power Pole			Subpanels			<input type="checkbox"/> Duct Htr(s) <input type="checkbox"/> Furnace(s)			FINAL APPROVAL		
<b>BUILDING</b>	Location, Set-backs, Esmt(s)			Exterior Wall Construction			Roof Covering Roof Drainage			Smoke Detector		
	Excavation						Exterior Lath			Demolition (sewer cap)		
	Footings & Reinforcing						<input type="checkbox"/> Interior Lath <input type="checkbox"/> Wallboard					
	Floor Slab			Interior Wall Construction			Fire Wall(s)			Building or Structure		
	Foundation Walls			Columns & Supports			Fireplace Chimney					
	Sub-soil Drain			Crawl Space <input type="checkbox"/> Vent <input type="checkbox"/> Access			Attic <input type="checkbox"/> Vent <input type="checkbox"/> Access					
	Piles			Floor System(s)						FINAL APPROVAL BLDG. DEPT.		
			Roof System			Special Insp Reports Rec'd			Certificate of Occupancy Issued			
<b>ADDITIONAL</b>	<b>INSPECTIONS, CORRECTIONS, ETC.</b>						<b>INSPECTIONS, CORRECTIONS, ETC.</b>					

**PERMIT**

**CITY OF NAPOLEON - BUILDING DEPARTMENT**

255 West Riverview Avenue, Napoleon, Ohio 43545 - 419-592-4010

Permit No. 01080 Issued August 28, 1985  
date

Job Location 615 Leonard  
address

Lot \_\_\_\_\_  
sub-div or legal discript

Issued By Richard G. Hayman  
building official

Owner Lucy Grieser  
name tel.

Address 615 Leonard

Agent John Gustwiller 395-2201  
builder-eng.-etc. tel.

Address RR 6 17117 Hill Rd Defiance

Description of Use Replace old service with  
new 100 amp

Residential Single Family  
no. dwelling units

Commercial \_\_\_\_\_ Industrial \_\_\_\_\_

New \_\_\_\_\_ Add'n. \_\_\_\_\_ Alter \_\_\_\_\_ Remodel \_\_\_\_\_

Mixed Occupancy \_\_\_\_\_

Change of Occupancy \_\_\_\_\_

Estimated Cost \$ \_\_\_\_\_

FEE	BASE	PLUS	TOTAL
BUILDING			
ELECTRICAL	5.00		5.00
PLUMBING			
MECHANICAL			
DEMOLITION			
ZONING			
SIGN			
WATER TAP			
SEWER TAP			
TEMP. ELECT.			
ADDITIONAL PLAN REVIEW	Struct. _____ hrs	Elect. _____ hrs	
TOTAL FEES.....			5.00
LESS MIN. FEES PAID _____ <small>date</small>			-0-
BALANCE DUE.....			5.00

**ZONING INFORMATION**

district	lot dimensions	area	front yd	side yds	rear yd
<u>A</u>					
max hgt	no pkg spaces	no ldg spaces	max cover	petition or appeal req'd	date appr

**WORK INFORMATION:**

Size: Length \_\_\_\_\_ Width \_\_\_\_\_ Stories \_\_\_\_\_ Ground Floor Area \_\_\_\_\_  
 Height \_\_\_\_\_ Building Volume (for demo. permit) \_\_\_\_\_ cu. ft.

Electrical: \_\_\_\_\_  
brief description

Plumbing: \_\_\_\_\_  
brief description

Mechanical: \_\_\_\_\_  
brief description

Sign: \_\_\_\_\_ Dimensions \_\_\_\_\_ Sign Area \_\_\_\_\_  
type

Additional Information: \_\_\_\_\_

Date \_\_\_\_\_ Applicant Signature \_\_\_\_\_  
owner-agent

**PAID**  
**SEP 01 1985**  
**CIty of Napoleon**

1918

NO.	DATE	PLACE	PLANT	COLLECTOR	CHARACTER	REMARKS
1	...	...	...	...	...	...
2	...	...	...	...	...	...
3	...	...	...	...	...	...
4	...	...	...	...	...	...
5	...	...	...	...	...	...
6	...	...	...	...	...	...
7	...	...	...	...	...	...
8	...	...	...	...	...	...
9	...	...	...	...	...	...
10	...	...	...	...	...	...
11	...	...	...	...	...	...
12	...	...	...	...	...	...
13	...	...	...	...	...	...
14	...	...	...	...	...	...
15	...	...	...	...	...	...
16	...	...	...	...	...	...
17	...	...	...	...	...	...
18	...	...	...	...	...	...
19	...	...	...	...	...	...
20	...	...	...	...	...	...

ENDING PLANT

...	...	...	...	...	...
...	...	...	...	...	...

WITH THE DIVISION

1918  
 U.S. DEPARTMENT OF AGRICULTURE  
 BUREAU OF PLANT INDUSTRY  
 WASHINGTON, D.C.

CITY OF NAPOLEON  
BUILDING INSPECTION DEPARTMENT  
APPLICATION FOR ELECTRICAL PERMIT  
(Please print or type)

The undersigned hereby makes application for installation or replacement of electrical equipment as herein specified, agreeing to do all such work in strict accordance with the City of Napoleon's adopted Electrical Codes.

Owner's Name Lucy Greiser Address 615 Leonard

Electrical Contractor John Mustweller Telephone No. 395-2201

Address RR #6 17117 Hill Rd Defiance

General Contractor \_\_\_\_\_ Telephone No. \_\_\_\_\_

Address \_\_\_\_\_

Location of Project \_\_\_\_\_ Cost of Project \_\_\_\_\_

Work Information:

Residential 1 Commercial \_\_\_\_\_ Industrial \_\_\_\_\_

No. Units

New \_\_\_\_\_ Service Change X Rewiring \_\_\_\_\_ Additional Wiring \_\_\_\_\_

Brief Description of Work: replace old service with 100 amp service in basement

Size of proposed service entrance 100 Number of new circuits NONE

Type of proposed service entrance \_\_\_\_\_ Underground \_\_\_\_\_ Overhead X

Require Temporary Electric NO (Yes or No)

Total Floor Area - Commercial and Industrial only \_\_\_\_\_ sq. ft.

Additional Information: \_\_\_\_\_

\*Ground fault circuit interrupter protection is required on all 120-volt single phase, 15 and 20 amp. Circuits which are part of a temporary electric service: and also on bathroom, outdoor, and garage receptacles in all dwelling units. Art. 220-8 N.E.C.

\*Application for permit shall be accompanied by two complete sets of plans including: Electrical layout and riser diagram. (For commercial and industrial work only).

Date 8-28-85

Applicant's Signature John Mustweller

PERMIT NO. 1080

PERMIT FEE \$ 5.00

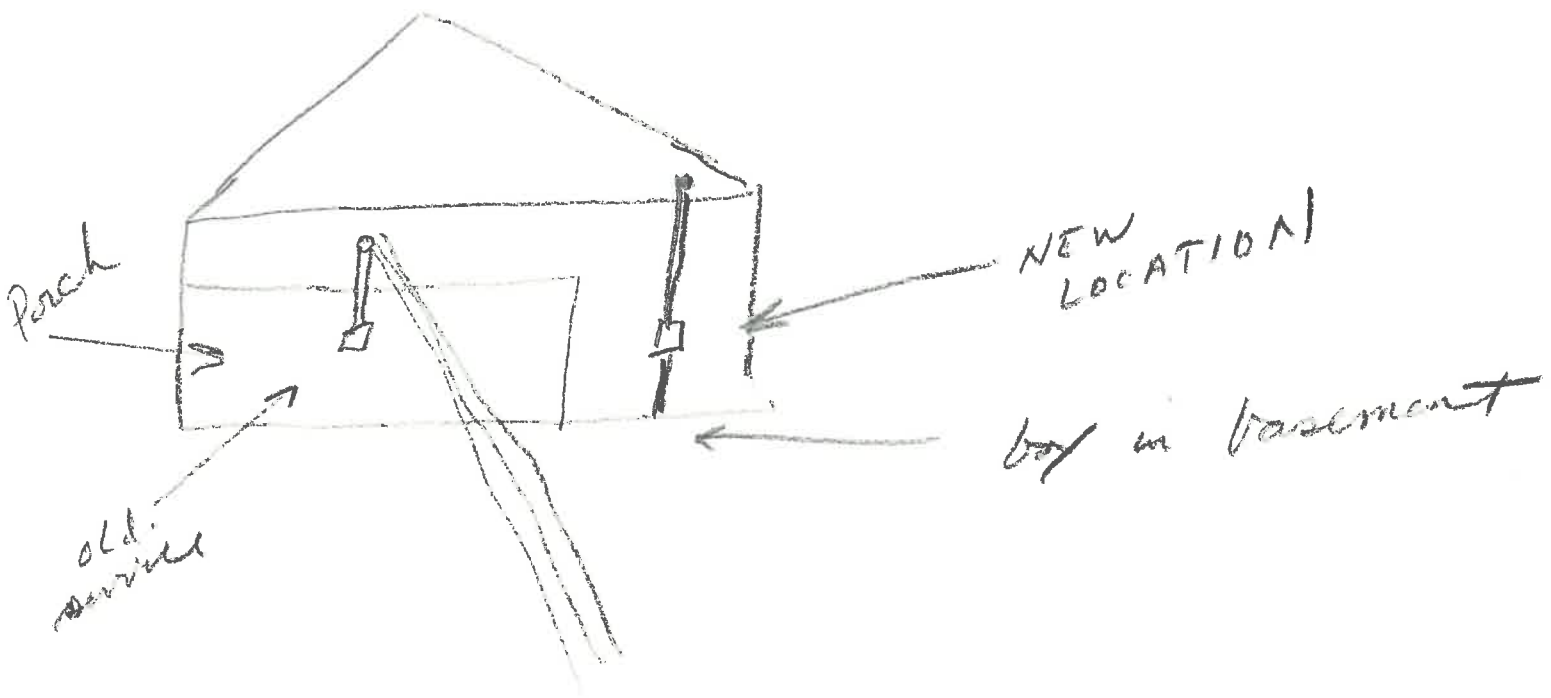

Porch

old.  
service

NEW  
LOCATION

boy in basement

